



USER MANUAL

DQ-CAM-GB2 Camera interface Nexa Modular GB2 2-Wire



INTRODUCTION

First and foremost we would like to thank you for purchasing this product.

Our commitment to achieving the satisfaction of customers like you is manifested through our ISO-9001 certification and the manufacture of products like the one you have just purchased.

Its advanced technology and strict quality control will ensure that customers and users enjoy the numerous features that this device offers. To get the most out of them and ensure proper operation from day one, we recommend that you read this instruction manual.

CONTENTS

Introduction.....	2
Contents.....	2
Set-up warnings.....	2
Safety precautions.....	2
Characteristics.....	2
Description of the DQ-CAM-GB2 camera interface.....	
Description.....	3
Installation.....	
Illustration of DQ-CAM-GB2 camera interface installation.....	3
Description of the DIP switches.....	4
Description of the status LEDs.....	5
Description of the CAM1~CAM4 buttons.....	5
RAP-2150 cable (Golmar) characteristics.....	5
Wiring diagrams.....	
Video door entry system installation with 4 analogue CCTV cameras.....	6
Notes.....	7

SET-UP WARNINGS

- Do not overtighten the screws on the Bus connection terminals of the DQ-CAM-GB2 module.
- Before connecting the device, check the connections of the DQ-CAM-GB2, the cameras and the FA-GB2A power supply.
- Use the Golmar **RAP-2150** cable (2x1mm²).
- Always follow the instructions contained in this manual.

SAFETY PRECAUTIONS

- **Always disconnect the power supply** before installing or making modifications to the device
- The fitting and handling of this device must be carried out by **authorised personnel**.
- The wiring must run at least **40 cm away from any other wiring**.
- Install the DQ-CAM-GB2 module in a dry protected location free from the risk of dripping or splashing water.
- Install the DQ-CAM-GB2 module with an FA-GB2A power supply.
- Avoid locations that are humid, dusty or near heat sources.
- Ensure that the air vents are free from obstruction so that air can circulate freely.
- To prevent damage, the DQ-CAM-GB2 module must be firmly secured in place.

CHARACTERISTICS

- DQ-CAM-GB2 camera interface module with simplified wiring (non-polarised 2-wire bus).
- DQ-CAM-GB2 camera interface module for the GB2 system (**do not use RD-GB2A modules in the same installation**):
 - ☞ 'Building' installation:
 - Up to 1 DQ-CAM-GB2 camera interface.
 - Up to 4 analogue CCTV cameras (the cameras must have their own power supply).
 - The camera interface must be installed on the door panel Bus side (see wiring diagram p. 6).
- **Important: Do not install the camera interface in installations with the RD-GB2A bus amplifier.**
- Configuration DIP switches.
- Status LEDs.
- Install the DQ-CAM-GB2 module with an FA-GB2A power supply.

DESCRIPTION OF THE DQ-CAM-GB2 CAMERA INTERFACE

Description:

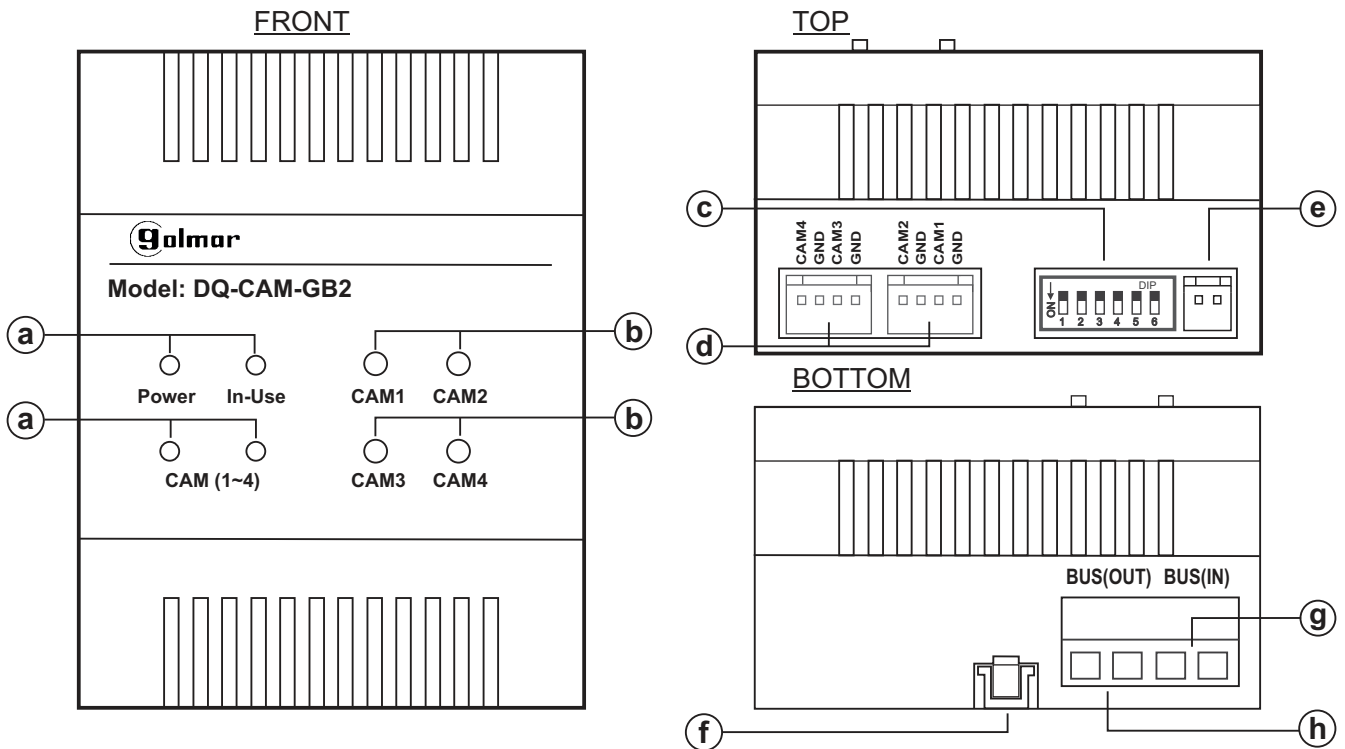

- a. Status LEDs.
- b. Buttons: control of CAM1-CAM4 video output.
- c. DIP switch.
- d. Connect to analogue CCTV cameras (1~4).

- e. Reserved.
- f. DIN rail latch release.
- g. Bus input terminals.
- h. Bus output terminals.

INSTALLATION

Illustration of DQ-CAM-GB2 camera interface installation:

Install the DQ-CAM-GB2 module in a dry protected location free from the risk of dripping or splashing water.
 Install the DQ-CAM-GB2 module with an FA-GB2A power supply.

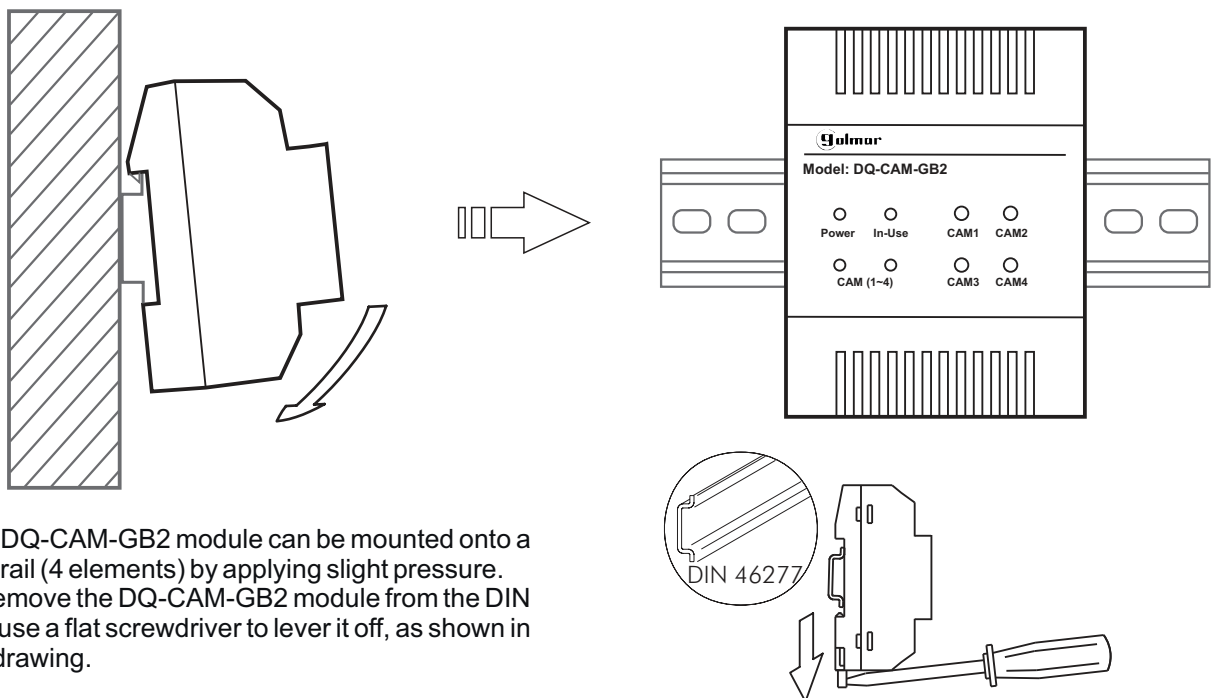

The DQ-CAM-GB2 module can be mounted onto a DIN rail (4 elements) by applying slight pressure. To remove the DQ-CAM-GB2 module from the DIN rail, use a flat screwdriver to lever it off, as shown in the drawing.

INSTALLATION

Description of the DIP switch:

The DIP switch is located at the top of the module.

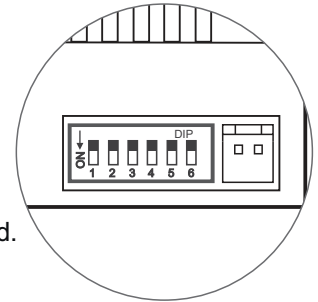

Leave DIP 1 and 2 in the OFF position.



Leave DIP 3 in the OFF position if cameras 3 and 4 have not been installed.



Set DIP 3 to ON if camera 3 is installed.

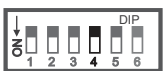

Set DIP 4 to OFF if camera 4 is not installed.

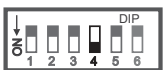

Set DIP 4 to ON if camera 4 is installed.



Set DIP 5 to OFF if display 'Mode A' is required in order to show the image of more than one camera on the monitor screen; (*) see display mode table.

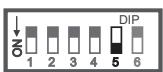

Set DIP 5 to ON if display 'Mode B' is required in order to show the image of more than one camera on the monitor screen; (*) see display mode table.



Set DIP 6 to OFF when the MM-GB2 module is not connected or it has no camera connected.



Set DIP 6 to ON when the MM-GB2 module is connected or it has a camera connected.

(*) Display mode table

	Mode A	Mode B
Two cameras:		
Three cameras:		
Four cameras:		

INSTALLATION

Description of the status LEDs:

The DQ-CAM-GB2 module has the following status LEDs:

Power:

LED on: Indicates that the device is operating normally.

In -use:

LED on: Indicates that the DQ-CAM-GB2 unit is broadcasting video.

CAM(1~4): Indicates the camera that is broadcasting video.

(*)The CAM (1~4) LEDs blink when the monitor shows the image of more than 1 camera.

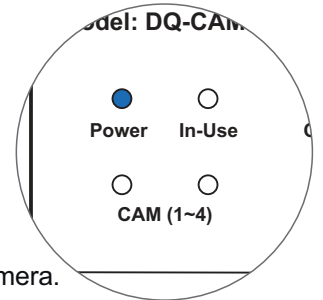

In-Use	CAM(1~4)		Description
●	○	○	CAM1 video output
●	●	○	CAM2 video output
●	○	●	CAM3 video output
●	●	●	CAM4 video output

● On indicator.

○ Off indicator.

(*) ● Blinking indicator.

Description of the CAM1 to CAM4 buttons:

The CAM1 to CAM4 buttons control the corresponding video output.

Important: The monitor must be in auto-on or communication.

Press the CAM1 button, the monitor displays the CAM1 image.

Press the CAM2 button, the monitor displays the CAM2 image.

Press the CAM3 button, the monitor displays the CAM3 image.

Press the CAM4 button and the monitor displays the CAM4 image.

Press the CAM4 button for 3 seconds, the monitor displays the image of all of the cameras.

(See DIP switch 5 'display mode' on p. 4).

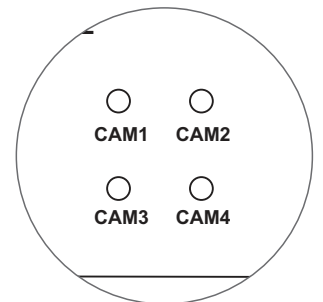

RAP-2150 (GOLMAR) CABLE CHARACTERISTICS

CONSTRUCTION CHARACTERISTICS	VALUES
Flexible 1mm ² twisted pair polished copper conductor	Class V
Wiring	15 V/m

ELECTRICAL CHARACTERISTICS	VALUES
Electrical resistance of the conductor at 20°C	19,5 Ω /Km
Capacity between conductors	45pf/m ± 10%
Characteristic impedance	100 Ω ± 10%

